

# STOCK COMMERCIAL TANKER

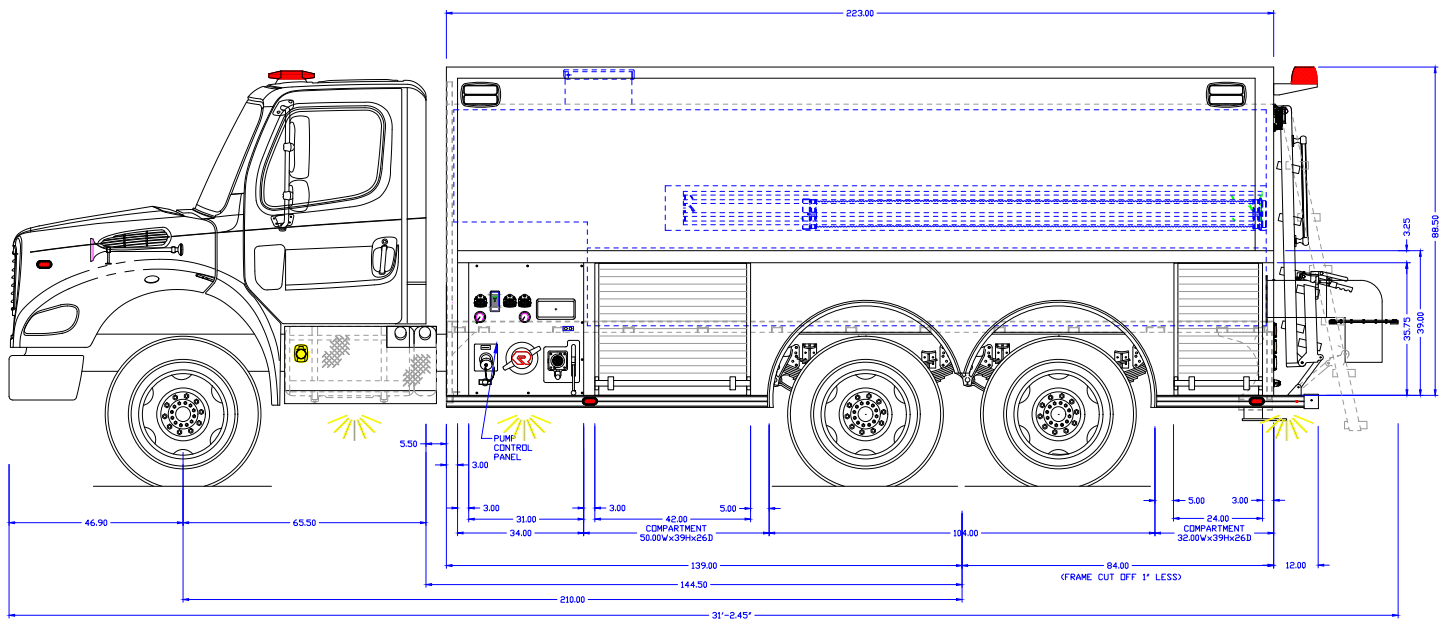

3000 GAL



## CHASSIS

- Freightliner M2 106+ chassis
- Seating for two (2)
- Cummins L9 450 hp engine
- Allison 3000 EVS transmission
- Axles 16,000# front 40,000# rear
- Electronic stability control
- Michelin tires
- Polished aluminum rims
- Heated mirrors
- 911 SCBA seats
- 50 gallon fuel tank
- Treadplate cab step overlays
- Hood mounted air horns

## PUMP & PLUMBING

- Darley HM 500 gpm pump
- FRC InControl TGA 300 governor
- 3000 gallon water tank
- Left and right side discharges
- Rear square dump with swivel
- 4" rear direct tank fill

## BODY

- Rosenbauer FX 1/8" aluminum body
- 5 year body construction warranty
- Hot dip galvanized sub frame
- Whelen warning light package
- 39" high compartments
- ROM roll-up doors
- ROM V3 LED compartment lighting
- Rosenbauer EZ climb ladder at the rear
- Storage for four (4) SCBA cylinders
- Folding tank storage in water tank
- Suction hose storage in water tank
- Equipped with suction hose and 3000 gallon folding tank

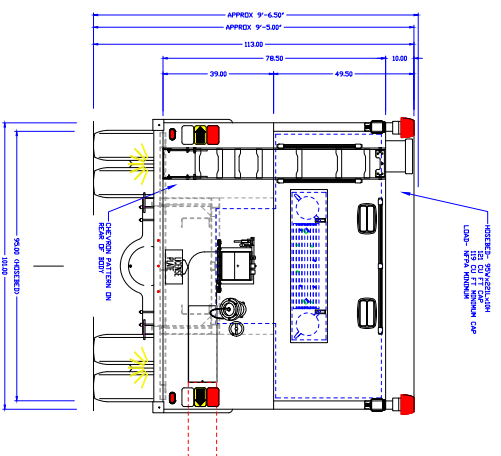
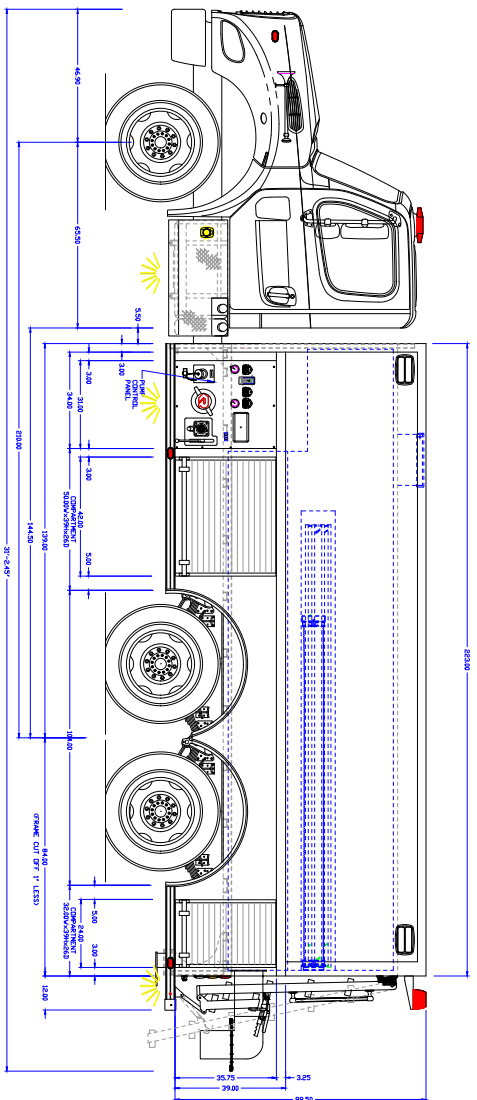

- NOTES:
1. OVERALL HEIGHT IS IN LOADED CONDITION, UNLOADED HEIGHTS MAY BE 4" ABOVE HEIGHTS SHOWN.
  2. DO NOT SCALE DRAWING.
  3. ALL DIMENSIONS ARE APPROXIMATE AND SUBJECT TO ENGINEERING CHANGES.
  4. DRAWING MAY OR MAY NOT SHOW ALL DIMENSIONS AND COMPONENTS. SEE DETAIL SPECIFICATIONS.
  5. INCLUSION OF AN ITEM ON THE DRAWING DOES NOT CONSTITUTE FINAL DELIVERED UNIT.
  6. THE EFFECTIVE DOOR OPENINGS WILL BE APPROX. 2" LESS THAN THE NOTED DOOR OPENINGS FOR THE ROLL UP DOOR. APPROX. 4" LESS FOR HINGED DOORS.

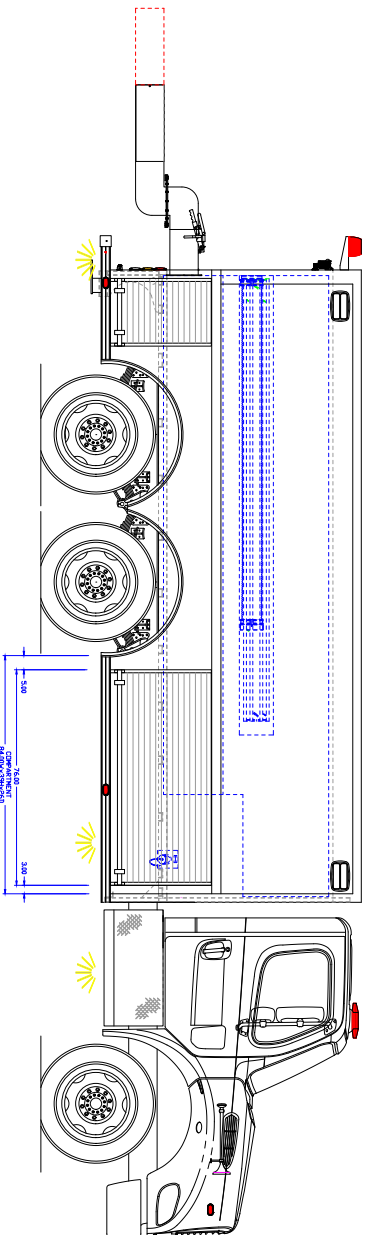

APPROVED BY: \_\_\_\_\_

CHASSIS: FREIGHTLINER  
 PUMP: DARLEY 500 GPM  
 TANK: POLY/3000  
 PANEL MATL: LINE X

REVISED -	DATE -
DRAWN - BPC	DATES-04-28-23

PROPRIETARY AND CONFIDENTIAL  
 THE INFORMATION CONTAINED IN THIS DRAWING IS THE PROPERTY OF ROSENBAUER. ANY REPRODUCTION IN PART OR AS A WHOLE WITHOUT THE WRITTEN PERMISSION OF ROSENBAUER IS PROHIBITED.

COMP INTERIOR:	SPATTER PAINTED
MAXIMUM HEIGHT	NONE
MAXIMUM LENGTH	NONE
BODY WIDTH	101"

**rosenbauer**

ROSENBAUER FX 1/8"